



19 Tarnbrook Way, Bracknell, Berkshire, RG12 0GT

Asking Price £270,000 Freehold

The Property

This two double bedroom home is set within the popular Forest Park area, close to local shops, schools and convenient for the major road network. The accommodation comprises of a spacious living room, kitchen and a bathroom. Outside there is a good sized garden and two allocated parking spaces to the rear. Other features include gas radiator heating and double glazed windows.

- Two Double Bedrooms
- Living Room
- Kitchen
- Bathroom
- Gas Radiator Heating
- Double Glazed Windows
- Garden
- Allocated Parking
- Close To Local Shops & Schools



Motorway Links

M3 Junction: 4.0 Miles
M4 Junction: 6.8 Miles



Train Links

Bracknell Station: 2.3 Miles
Martins Heron Station: 1.1 Miles



Nearest Schools:

Crown Wood 0.4 Miles
Harmans Water 0.9 Miles
Brakenhale 2.1 Miles
Ranelagh 2.1 Miles

19 Tarnbrook Way, Bracknell, RG12 0GT

duncan
yearley

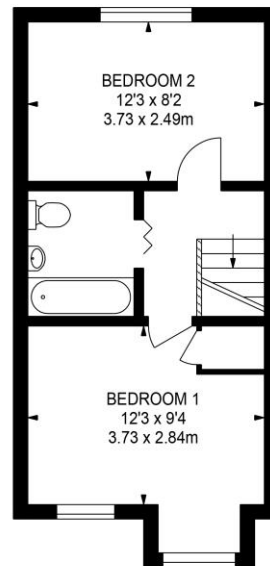
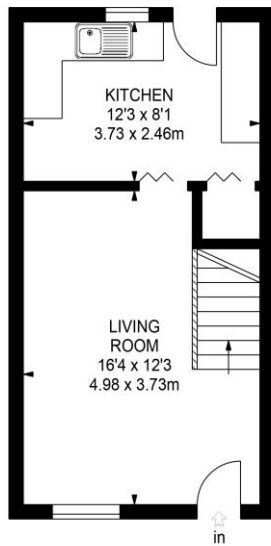

APPROX. GROSS INTERNAL FLOOR AREA 623 SQ FT / 57.88 SQ M

This plan is for layout guidance only. Not drawn to scale unless stated. Windows & door openings are approximate. Whilst every care is taken in the preparation of this plan, please check all dimensions, chances & connections before making any decisions reliant upon them.

01344 860 121 • sales@duncanyearley.co.uk

9 Crown Row, Bracknell, RG12 0TH • duncanyearley.co.uk

These particulars have been produced with the approval of our client, but all measurements should be taken as approximate and we do not recommend using them as a guide for floor coverings. Purchasers must satisfy themselves as to the condition of the property/outbuildings and to the condition and serviceability of any fixtures and fittings, including the central heating system and boiler etc. NB: Please note that we have not checked whether the property, or any part of it, complies with the planning acts or building regulations. This should be checked by your surveyor or solicitor.



sales • lettings & management

duncan
yearley