

46 Simmonds Close, Bracknell, Berkshire, RG42 1FL

£190,000 Leasehold

The Property

This one bedroom ground floor apartment is set in a cul-de-sac in the Amen Corner development to the West of Bracknell Town Centre. The accommodation comprises an impressive living/dining room, kitchen, double bedroom and a bathroom. Outside there is a private rear garden with access from the living area and residents parking

- Extended Lease
- Ground Floor Apartment
- Double Bedroom
- Living/Dining Room
- Kitchen
- Bathroom
- Private Garden
- Residents Parking
- No Onward Chain
- Cul-De-Sac
- Amen Corner Location



Motorway Links

M3 Junction: 7.0 Miles
M4 Junction: 4.1 Miles



Train Links

Bracknell Station: 1.4 Miles
Martins Heron Station: 3.4 Miles



Nearest Schools:

Meadow Vale 0.6 Miles
Bnfield CE 1.4 Miles
Brakenhale 2.2 Miles
Ranelagh 2.7 Miles

A One Double Bedroom Apartment With No Onward Chain & Extended Lease

46 Simmonds Close, Bracknell, RG42 1FL

duncan
yearley

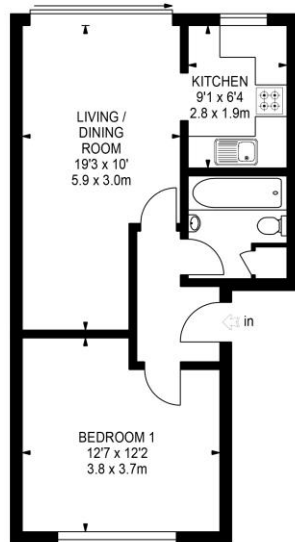

APPROX. GROSS INTERNAL FLOOR AREA 468 SQ FT / 43.48 SQ M

This plan is for layout guidance only. Not drawn to scale unless stated. Windows & door openings are approximate. Whilst every care is taken in the preparation of this plan, please check all dimensions, shapes & compass bearings before making any decisions reliant upon them.

01344 860 121 • sales@duncanyearley.co.uk

9 Crown Row, Bracknell, RG12 0TH • duncanyearley.co.uk

These particulars have been produced with the approval of our client, but all measurements should be taken as approximate and we do not recommend using them as a guide for floor coverings. Purchasers must satisfy themselves as to the condition of the property/outbuildings and to the condition and serviceability of any fixtures and fittings, including the central heating system and boiler etc. NB: Please note that we have not checked whether the property, or any part of it, complies with the planning acts or building regulations. This should be checked by your surveyor or solicitor.

duncan
yearley



sales • lettings & management