



Flat 4, Laurel Court, Wayland Close, Bracknell, RG12 9PB

Offers In Excess Of £170,000 Leasehold /Share of Freehold

The Property

This first floor apartment is set in a cul-de-sac, close to Martins Heron railway station and Tesco superstore. The well-planned accommodation comprises of a double bedroom, living room, separate kitchen and a bathroom. Outside there are communal grounds surrounding the property and residents parking. Extended lease with 990 years remaining.

- First Floor Apartment
- Double Bedroom
- Living Room
- Separate Kitchen
- Bathroom
- Communal Grounds
- Residents Parking
- Close to Martins Heron Station
- Extended 990 Year Lease Remaining
- Share Of The Freehold



Motorway Links

M3 Junction: 5.7 Miles
M4 Junction: 6.6 Miles



Train Links

Martins Heron Station: 0.5 Miles
Bracknell Station: 2.1 Miles



Nearest Schools:

Harmans Water 0.5 Miles
Crown Wood 1.1 Miles
Ranelagh 1.4 Miles
Brakenhale 1.5 Miles

Flat 4, Laurel Court, Bracknell, RG12 9PB

duncan
yearley

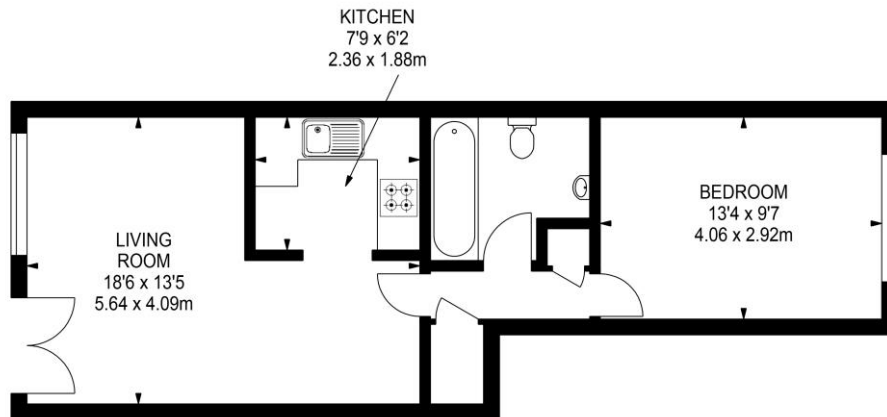

APPROX. GROSS INTERNAL FLOOR AREA 468 SQ FT / 43.47 SQ M

This plan is for layout guidance only. Not drawn to scale unless stated. Windows & door openings are approximate. Whilst every care is taken in the preparation of this plan, please check all dimensions, shapes & compass bearings before making any decisions reliant upon them.
Estate Services © 2019 www.estateservicespcs.co.uk

01344 860 121 • sales@duncanyearley.co.uk

9 Crown Row, Bracknell, RG12 0TH • duncanyearley.co.uk

These particulars have been produced with the approval of our client, but all measurements should be taken as approximate and we do not recommend using them as a guide for floor coverings. Purchasers must satisfy themselves as to the condition of the property/outbuildings and to the condition and serviceability of any fixtures and fittings, including the central heating system and boiler etc. NB: Please note that we have not checked whether the property, or any part of it, complies with the planning acts or building regulations. This should be checked by your surveyor or solicitor.



sales • lettings & management

duncan
yearley